

MODEL LPD

LOW PROFILE DIRECT DRIVE

CENTRIFUGAL ROOF/SIDEWALL EXHAUSTER

FEATURES

- Ultra low profile
- AMCA Air & Sound Licensed
- UL 705 listed
- UPS shipping carton
- 5 year housing warranty
- Up to 140°F airstream temperature
- Roof or sidewall mount



CONSTRUCTION

- Aluminum construction
- Stainless steel exterior fasteners
- Backward curved centrifugal wheel
- Aluminum birdscreen
- Conduit wiring chase
- Service disconnect switch
- Precision balanced to ISO Standard 1940

AMCA SEAL



JencoFan, Div. of Soler & Palau Ventilation Group, certifies that the Models LPD shown herein are licensed to bear the AMCA Seal. The ratings shown are based on test and procedures performed in accordance with AMCA Publication 211 and AMCA Publication 311 and comply with the requirement of the AMCA Certified Ratings Program.

MOTOR

- Unique external rotor design
- Permanently lubricated bearings
- 3 year motor warranty
- Internal thermal protection
- 100% speed controllable
- Totally enclosed and continuous duty



LISTED POWER ROOF VENTILATOR
UL STANDARD 705

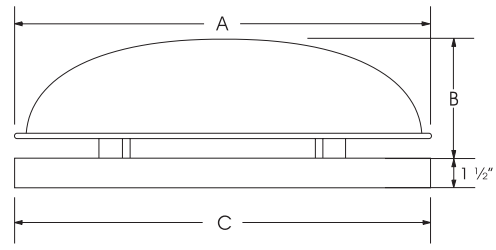

DIMENSIONAL DATA

MODEL LPD	O.D. DAMPER	ROOF OPENING	CURB O.D.	A	B	C	AVERAGE SHIP WT. LBS.
6	11	11-3/4	14-3/4	16-1/2	7	16-1/2	12
8	11	11-3/4	14-3/4	16-1/2	7	16-1/2	15

PERFORMANCE DATA

MODEL LPD	CFM @ STATIC PRESSURE											RPM (NOM.)	MAX MOTOR WATTS & AMPS	SONES @ 1/2"	VENTILATOR WITH TE MOTOR
	0	1/8	1/4	3/8	1/2	5/8	3/4	1	1 1/4	1 1/2	1 3/4				115/1/60 STOCK NO.
6	302	268	247	222	197	175	155	118	87	52	-	2800	90 WATTS 0.8 AMPS	7.2	LPD061AS ●
8	387	358	331	303	275	245	222	178	138	98	63	2775	115 WATTS 1.0 AMPS	11.9	LPD081AS ●

Performance certified is for installation type A-free inlet, free outlet. Performance ratings include the effects of birdscreen in the airstream. The sound ratings shown are loudness values in fan sones @ 5' (1.5m) in a hemispherical free field calculated per AMCA Standard 301. Installation Type A: free inlet hemispherical sone levels.

*Base unit=AMCA Seal for Sound Rating does not apply to units with speed control + RPM range capable with solid state speed control. Speed (RPM) shown is normal. Performance is based on actual speed of test.

ACCESSORIES

MODEL LPD	12" HIGH ROOF CURB	GRAVITY DAMPER	DAMPER MOTOR (LOOSE)	115 VOLT SPEED CONTROL
	STOCK NO.	STOCK NO.	STOCK NO.	STOCK NO.
6	611214 ●	411011 ●	411611 ●	2727.1 ●
8	611214 ●	411011 ●	411611 ●	2727.1 ●

Ship Schedules:
● Next Day Shipment From Stock

ALL DIMENSIONS IN INCHES, WEIGHTS IN POUNDS. OD IS OUTSIDE DIMENSION OF SQUARE CURB AND DAMPER. DUE TO CONTINUING RESEARCH, Jencofan RESERVES THE RIGHT TO CHANGE SPECIFICATIONS WITHOUT NOTICE. Please refer to the General Catalog or contact the Factory for our Full Line of products available on standard shipping schedules.